

ASHLEY  
BOTTEN  
DESIGN

## corner mirror



### **description**

Part of Ashley's design philosophy is to create moments within an interior that make you stop and look, by noticing an unexpected object on a tabletop or observing an unusual placement of things. Corner Mirror was inspired by a similar desire of animating the point in a room that is rarely considered. Positioned at the juncture where two walls meet, the mirror becomes an unexpected focal point. Its reflective surface is obscured by a moody black finish of watery markings. The real beauty of Corner Mirror, though, is how owners will use it and make it their own.

Made to order and handcrafted in Toronto

### **dimensions**

height: 13" (33cm)  
width (front): 9.5" (24.1cm)  
width (side): 4.5" (11.4cm)  
depth: .06" (.15cm)

### **metal finishes**



steel



copper

### **shipping and delivery**

This item is custom made to your exact needs. Typically, it will be ready to ship within 4 to 6 weeks after purchase.

---

72 stafford street, suite 100 . toronto, ontario m6j 2r9  
416.203.9363 . concierge@ashleybottendesign.com

**ashleybottendesign.com**

ASHLEY  
BOTTEN  
DESIGN

corner mirror

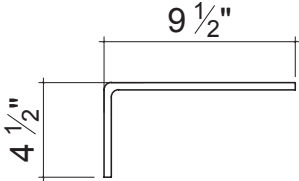

PLAN

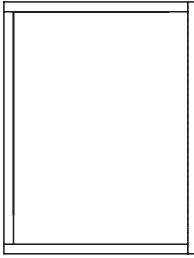

METAL SHEET EDGES WRAP  
AROUND 1/2" FRAME ALSO  
FUNCTIONS AS HANGING  
BRACKET

BACK

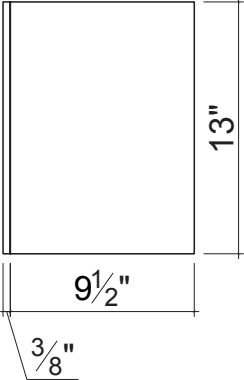

FRONT

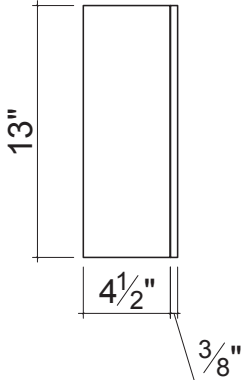

SIDE